

Solar Module: MyECO MM130 Series

MM125/MM130/MM135/MM140/MM145 (6" Mono-crystalline Solar Cell, 4x9pcs)



Front View

(Photo in preparation)



Technical Drawing

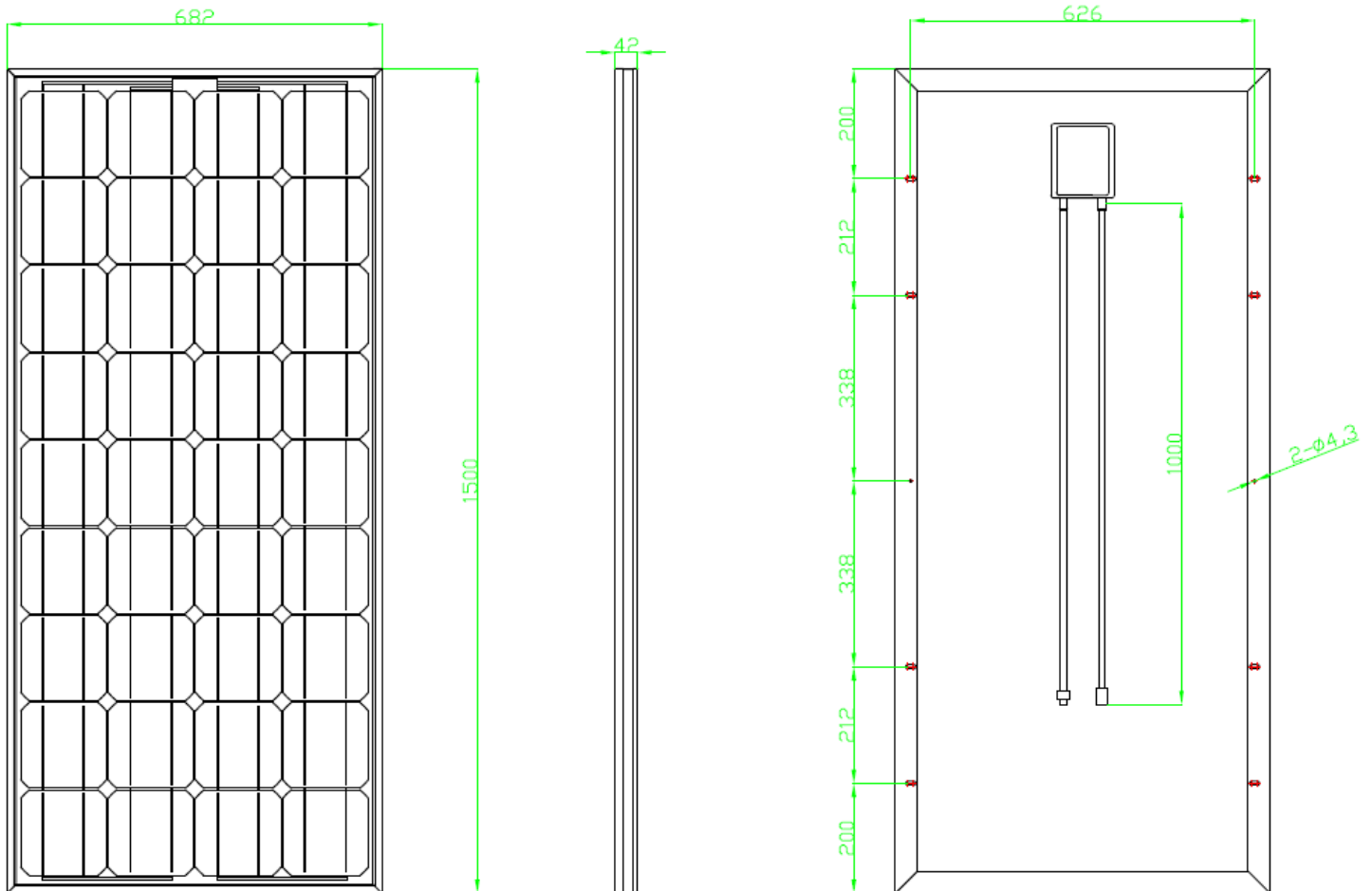

Product Characteristics

Electrical Characteristics: Performance at STC*1

Model Type	MM125	MM130	MM135 (CEC Listed)	MM140 (CEC Listed)
Nominal Peak Power, Pmax	125W ± 5%	130W ± 5%	135W ± 5%	140W ± 5%
Peak Power Voltage, Vpm	16.96 V	17.09 V	17.29 V	17.56 V
Peak Power Current, Ipm	7.40 A	7.55 A	7.74 A	7.83 A
Open Circuit Voltage, Voc	21.81 V	22.06 V	22.35 V	22.52 V
Short Circuit Current, Isc	8.06 A	8.20 A	8.37 A	8.50 A
Module Efficiency	12.22%	12.71%	13.20%	13.69%

*STC: Standard Test Condition, 1000W/m², AM 1.5, 25°C



For the sake of our planet earth, please think again before you print.

Ver.2-1 10/2009



Electrical Characteristics: Performance at STC*1

Model Type	MM145 (CEC Listed)		
Nominal Peak Power, Pmax	145W \pm 5%		
Peak Power Voltage, Vpm	17.97 V		
Peak Power Current, Ipm	8.20 A		
Open Circuit Voltage, Voc	22.79 V		
Short Circuit Current, Isc	8.30 A		
Module Efficiency	14.17%		

*STC: Standard Test Condition, 1000W/m², AM 1.5, 25°C

System Integration Parameter

Maximum System Voltage	1000VDC (600VDC in US)
Series Fuse Rating	10A
Operating Temperature	-40 to 85°C

Thermal Characteristics

NOCT (Nominal Operating Cell Temperature)	46.5°C
Temperature Coefficient TK Pmax (Peak Power)	-0.403%/°C
Temperature Coefficient TK Voc (Open Circuit Voltage)	-0.288%/°C
Temperature Coefficient TK Isc (Short Circuit Current)	+0.086%/°C

Current-Voltage Characteristics (I-V Curve) at various irradiance levels

(Data in preparation)

Component materials

Cell Qty per Module	36pcs
Cell Type	Mono-crystalline Silicon
Cell Dimensions	156 x 156 mm
Laminate Construction	Front: Tempered Glass Encapsulation: Solar Cells Embedded in EVA (Ethylene-Vinyl-Acetate) Rear: Tedlar
Glass	Low-Iron Tempered Glass, 3.2mm (>3.2mm, ex. 4mm or above, custom-made possible)
Junction Box	IP65, TÜV Certified & UL Listed
Bypass Diodes	1pcs, TÜV Certified & UL Listed
Cable	TÜV Certified & UL Listed
Connector	TÜV Certified & UL Listed
Frame	Anodized Aluminum Frame. Color: Silver

Physical Specifications

Dimension [L x W x H]	1500 x 682 x 42 mm
Weight (Kg)	14 Kg

Packing Specifications

Modules Per Carton	2pcs/carton
Module Per Pallet	22/23pcs/pallet
20ft Container Capacity	484/506
40ft Container Capacity	1012/1058

Performance Warranty

90% Output	10Years
80% Output	20Years

Certification

ISO 9001:2000 Quality Management	Certified
IEC 61215:2005	TÜV certified
EN 61730-1 & EN 61730-2:2007	TÜV certified
UL1703 Ed:3 Rev:2004	Certified according to UL safety standard
ULC/ORD-C1703-01 Second Edition	Certified according to Canadian safety standard
CEC Listing	http://www.gosolarcalifornia.ca.gov/equipment/pvmodule.html

Quality Assurance

1. Electrical Insulation Test	2. Outdoor Exposure Test
3. Hot-Spot Endurance Test	4. UV-exposure
5. Thermal Cycling Test	6. Humidity Freeze Test
7. Damp Heat Test	8. Robustness of Terminations Test
9. Wet Leakage Current Test	10. Mechanical Load Test
11. Hail Impact Test	12. Bypass Diode Thermal Test

Features:

The most reliable quality

Good conversion efficiency of solar module (*efficiency to be affected by glass thickness & the color of back sheet)

Effectively minimize the power drop by the shade

High-level protection for severe environment

High quality glass provides for less reflection of incoming sunrays

Warranty of minimal power output 80% at STC for 20 years

Color of the back sheet: White & Black (custom-made possible)

Though the technical information has been carefully verified and corrected, error data could still be misplaced within. Above data will be subject to change without prior notice due to actual manufacturing condition and design. Please surf for the latest updates on Ritek website (<http://www.ritek.com/>, <http://www.riteksolar.com/>) or contact us.

Ritek Corporation: Headquarter Office | www.ritek.com | www.riteksolar.com |
 No. 17, Kuang-Fu N. Rd., Hsin-Chu Industrial Park, Hu-Kou Township, Hsin-Chu County, Taiwan 30351
 E-mail: ritsolar@ritek.com.tw Tel: +886-3-5985696 Ext. 4011 & 4013(for Global Sales Contact), Ext. 4020, 4021, & 4012(for Local Sales Contact in Taiwan)

US Branch Office: Advanced Media, Inc. | www.ritekusa.com |
 1440 Bridge Gate Dr., Suite 395, Diamond Bar, CA91765, USA
 E-mail: solarsales@ritekusa.com Tel: +1-909-861-2269

Europe Branch Office:

China Branch Office:

MyECO and MyECO logo are registered trademarks and/or trademarks of Ritek Corporation. All other registered trademarks are the property/trademarks of their respective owner.